

Walplast®  
**HOMESURE**  
TILE ADHESIVE

**MILAYE  
SIRF PAANI  
LAGAYE BINA  
PARESHAANI®**



**20 Kg Bag | PACKAGING**

**Highlights**

**Platinum Class**

- ✓ No Need For Hacking
- ✓ Highly Water Resistant
- ✓ Excellent Adhesion To Base Plaster/Concrete Surface
- ✓ Can Be Used On New As Well As Old Wall And Floor

## HOW TO APPLY

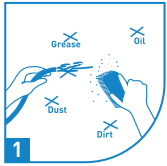

1 Clean the surface with sand paper/putty blade & then dampen the surface.

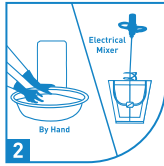

2 Mix Tile Adhesive & water to obtain lump free paste. (Recommended mix Approx.30% water)



3 After 10 minutes, remix again for 2 minutes.

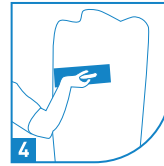

4 Apply first coat with putty blade.

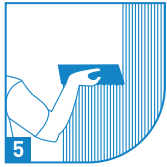

5 With the help of 6mm notch trowel remove excess material prior placing the tiles.



6 Fix the tiles in place & tap gently with wooden hammer. Gently remove excess mixture from the tiles.

**Note:** Maximum thickness should not be more than 3mm.

## TECHNICAL INFORMATION

TEST	TEST METHOD	RESULTS
Physical Appearance	Visual	Grey cementitious powder
Open Time	IS-15477-2004	>20 minutes
Pot Life	Internal	>30 minutes
Spreadability	Internal	Spread easily with good notchability
Adjustability	IS 15477:2004	10 minutes

PRODUCT	COVERAGE	USED FOR	APPROXIMATE WATER DEMAND
PLATINUM CLASS	2-3 sqft/kg for 3mm thickness	Stones	20kg - 6 to 6.5 liters

## KEY FEATURES

- High durability
- Suitable for interior & exterior walls
- No shrinkage
- Saves time
- Increases productivity
- Cost-Effective
- No curing required
- Consistent work quality



STORAGE



**Walplast Products Pvt. Ltd.** ISO 9001 : 2015 Certified Company

**Corporate Office:** Rainbow Building, Plot No. 13, Sector - 24, Mumbai Pune Highway Service Road, Turbhe, Navi Mumbai - 400 705, Maharashtra, India. Tel no.: 022-41418282. Enquiry No.: 1800 3000 6650

Email: [sales@walplast.com](mailto:sales@walplast.com), [customercare@walplast.com](mailto:customercare@walplast.com) / For more details visit us at: [www.walplast.com](http://www.walplast.com)

**Disclaimer:** The product information and application details given by the company and its agents has been provided in good faith and meant to serve only as a general guideline during usage. Users are advised to carry out test and take trials to ensure on the suitable of the products meeting their requirement prior to the full scale usage of our products. Since the correct identification of the problems, quality or other materials used and the on-site workmanship are factors beyond our control, there are no guarantee/warranty as to the result obtained. The company does not assure any liability for unsatisfaction results arising from the use of our products.