

Walplast®

BUILDWELL

EXTERNAL TEXTURE

MILAYE
SIRF PAANI
LAGAYE BINA
PARESHAANI™



30 Kg Bag | PACKAGING

Highlights

- ✓ Hides Cracks
- ✓ Cost-Effective
- ✓ White Cement Based Polymer Modified Texture
- ✓ Protection Of Plasters

HOW TO APPLY

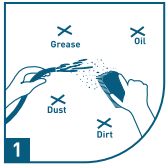

1 Clean the surface with sand paper/wire brush or putty blade for removing loose particles.

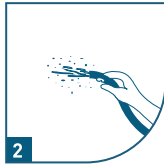

2 Dampen the surface with clean water & allow excess water to drain off.

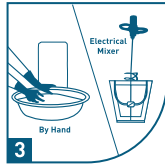

3 Add Texture in water to obtain a lump free paste & mix well. (Recommended mix 15-20% water)



4 Let it stand for 10 minutes for all the additives to dissolve completely.

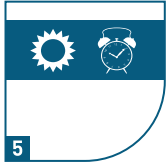

5 Remix again for 2 minutes. Use the prepared mix within 30 minutes.



6 Apply in patches and with the help of plastic/fiber trowel and move uniformly on the surface to get the desired texture pattern and uniform leveling.

TECHNICAL INFORMATION

TEST	TEST METHOD	SPECIFICATION	RESULTS
Physical Appearance		White to pale cream	White to pale cream
Drying Time (Dry to Touch)	Internal	0-1 Hour	50 min
Drying Time (Tack Free)	Internal	Max 8 Hour	5

PARAMETER	SPECIFICATION
Physical state	Ready to use dry mix powder
Appearance	White to pale cream
Pot life	60 minutes
Dry to touch @ 30Deg.	0-1 Hrs. @ 30Deg.
Tack free @ 30Deg.	Max 8 Hrs.

COVERAGE
150 to 180 sq.ft. / bag (Depending on surface of the wall)
External Texture (2 - 3 mm)



Walplast Products Pvt. Ltd. ISO 9001 : 2015 Certified Company

Corporate Office: Rainbow Building, Plot No. 13, Sector - 24, Mumbai Pune Highway Service Road, Turbhe, Navi Mumbai - 400 705, Maharashtra, India. Tel no.: 022-41418282. Enquiry No.: 1800 3000 6650

Email: sales@walplast.com, customercare@walplast.com / For more details visit us at: www.walplast.com

Disclaimer: The product information and application details given by the company and its agents has been provided in good faith and meant to serve only as a general guideline during usage. Users are advised to carry out test and take trials to ensure on the suitability of the products meeting their requirement prior to the full scale usage of our products. Since the correct identification of the problems, quality or other materials used and the on-site workmanship are factors beyond our control, there are no guarantee/warranty as to the result obtained. The company does not assure any liability for unsatisfaction results arising from the use of our products.

KEY FEATURES

- Excellent UV Resistance
- Good workability & high durability
- It is highly compatible with plaster and concrete wall surface
- Excellent resistance against the growth of algae & fungi on the wall
- Provides best value for money
- Tough Textured



STORAGE

